

SF15 Configuration and Accessories

Mold Injection Connector (IP68 Factory Assembly Only)

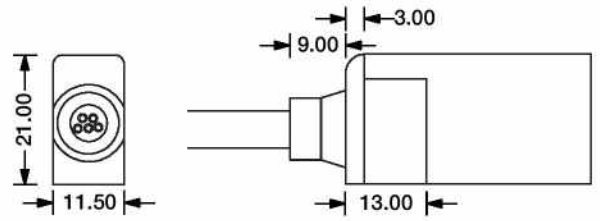

Direct Entry Connector
MJ-SF15-D5-D02SM
MJ-SF15-D5-D03SFM



Side Entry Connector
MJ-SF15-D5-S02SM
MJ-SF15-D5-S03SFM

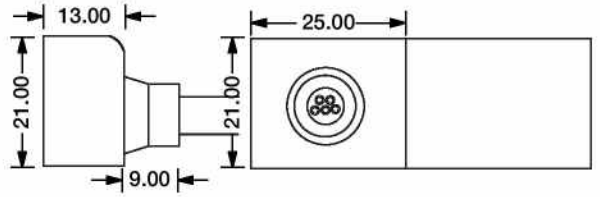

Bottom Entry Connector
MJ-SF15-D5-B02SM
MJ-SF15-D5-B03SFM

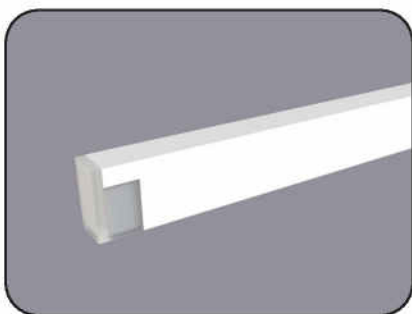
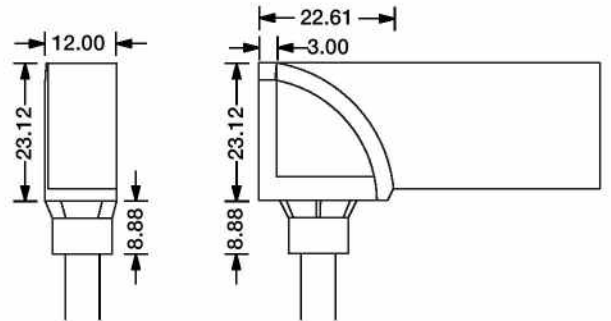

End Cap

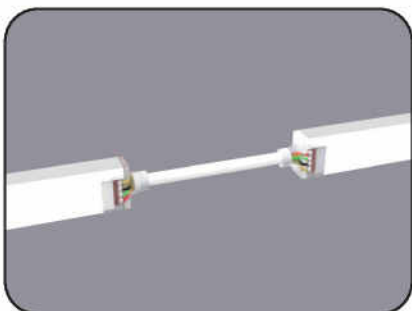
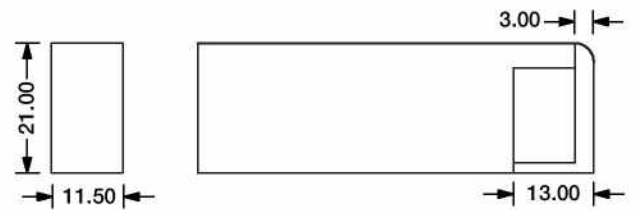

Jumper
MJ-SF15-D5-D-JC

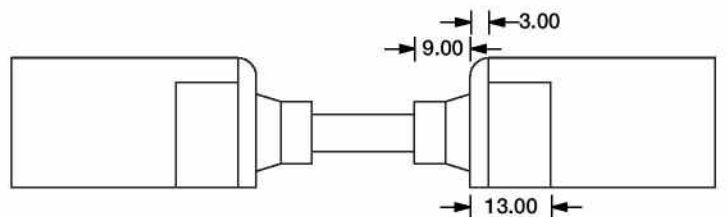

SF15 Configuration and Accessories



DIY Snap End Cap
DIY-SN-END-15-D-01/02

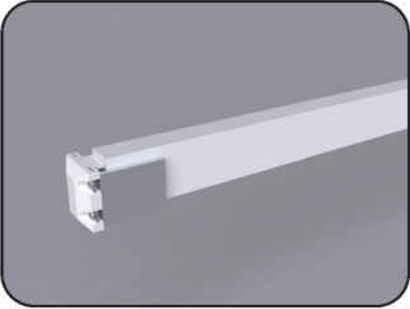
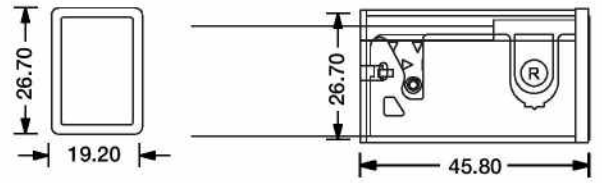

DIY Screw End Cap
DIY-SC-END-15

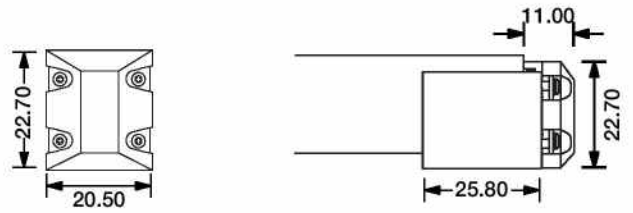

Male Connector
M12-M-5C-18AWG+24AWG-D6-W-0327-S

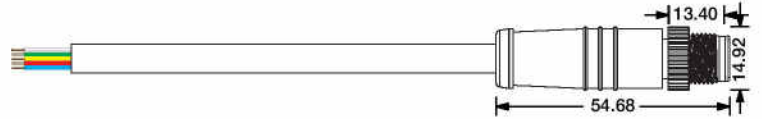

Female Connector
M12-F-5C-18AWG+24AWG-D6-W-0327-S



Front Signal & Power Connector
FR-CNR-DMX-2T1

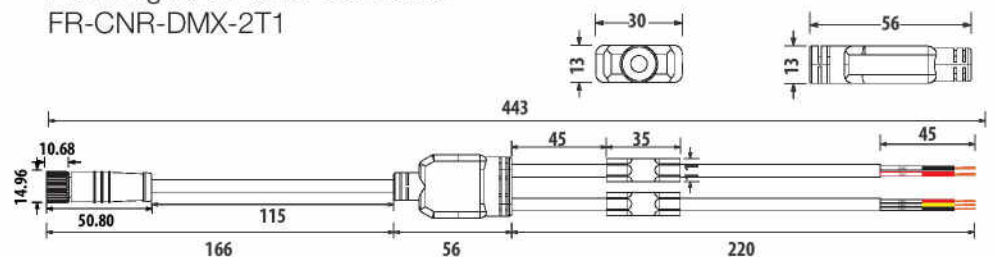

SF15 Configuration and Accessories

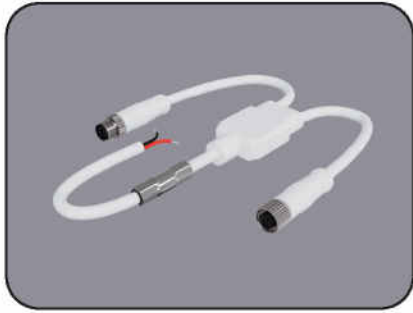

Middle Power Connector (1 to 2)
MID-CNR-512C3-1T2

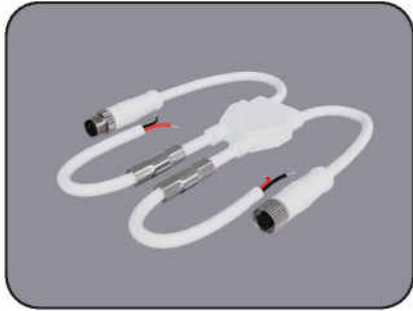
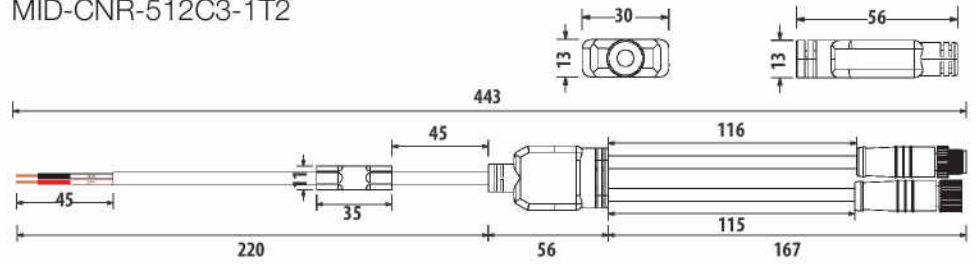

Middle Power Connector (2 to 2)
MID-CNR-512C3-2T2

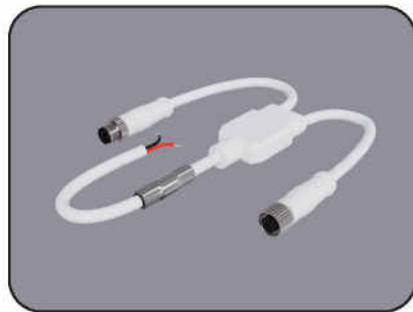
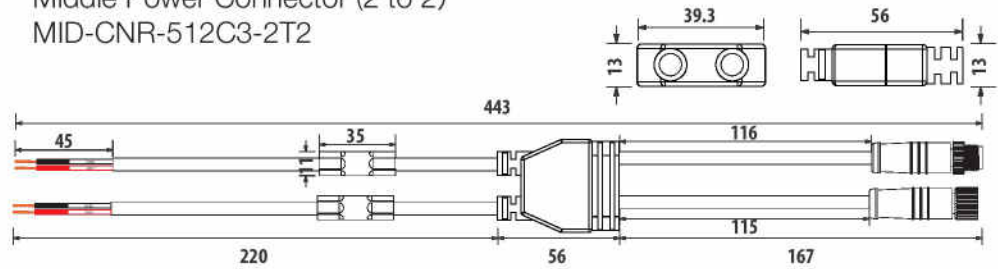

Middle Signal Connector
MID-SIG-CNR-512C3-1T2

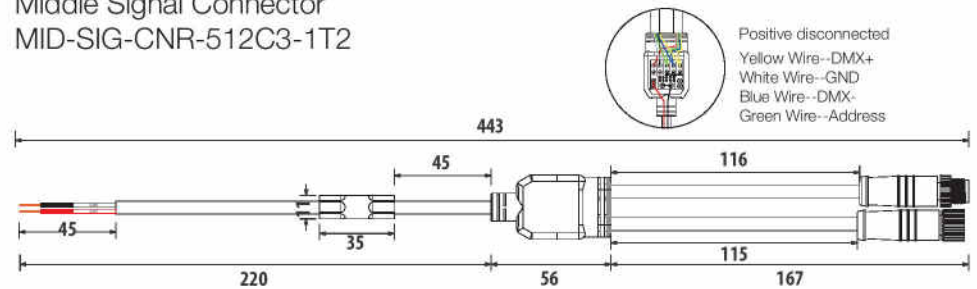

Positive Disconnected Connector Cable
M12-EXT-SIG-5C-20AWG-D6-W-015

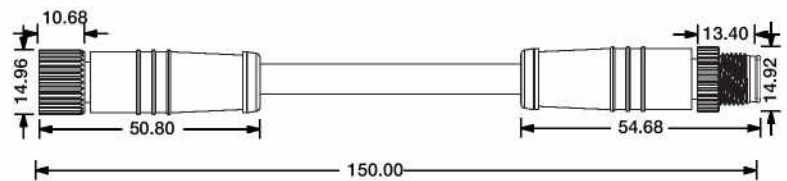

Male Connector End Cap
SYZ-EC-M12-M

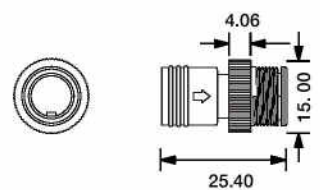

SF15 Configuration and Accessories



Female Connector End Cap
SYZ-EC-M12-F-5C

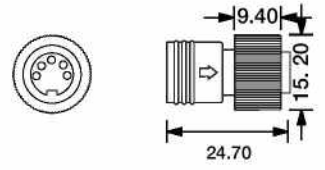

LED Linear Flex Mounting Channel

1. Aluminum Channel

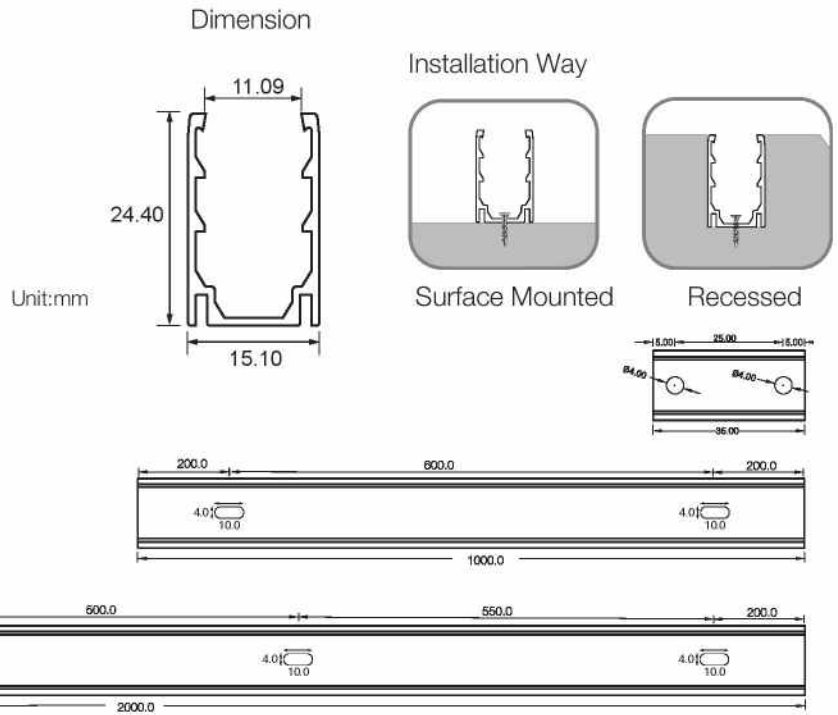

Model	W x H(mm)	Standard Length	Screw Holes	Holes Numbers	Suitable Product
ALC15S01-035	15.10*24.40	35mm	Φ4.0mm	2	F15, SF15
ALC15S01-100		1000mm	○4.0mm	2	F15, SF15
ALC15S01-200		2000mm	○4.0mm	4	F15, SF15

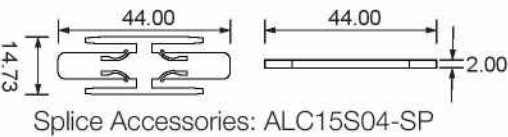
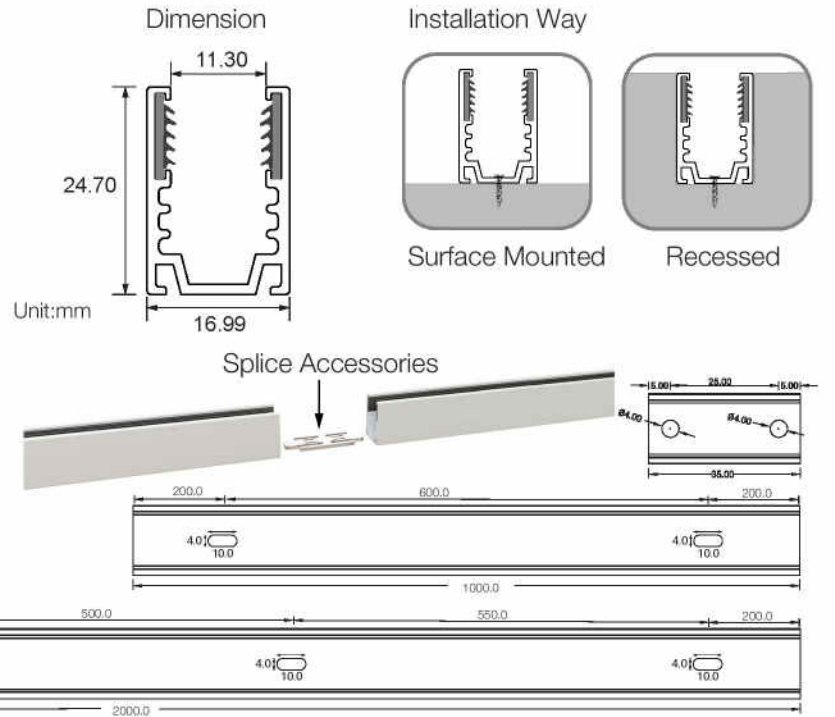

Model	W x H(mm)	Standard Length	Screw Holes	Holes Numbers	Suitable Product
ALC15S04-035	16.99*24.70	35mm	Φ4.0mm	2	F15, SF15
ALC15S04-100		1000mm	○4.0mm	2	F15, SF15
ALC15S04-200		2000mm	○4.0mm	4	F15, SF15

LED Linear Flex Mounting Channel



ALC15H05

Unit:mm

Dimension

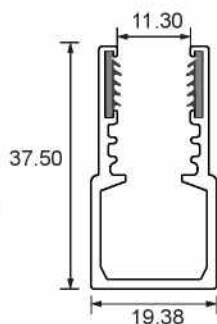

Installation Way

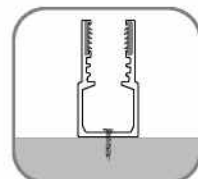

Surface Mounted

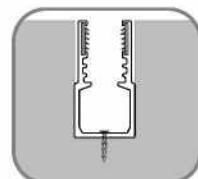

Recessed

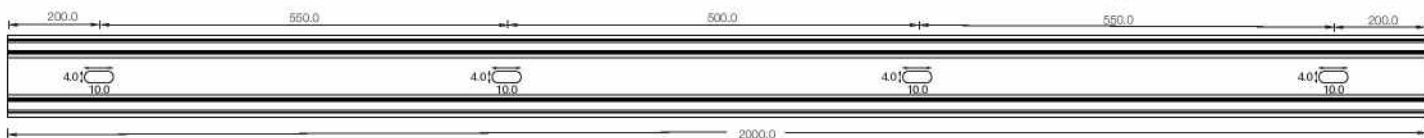
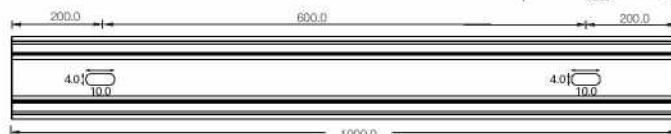
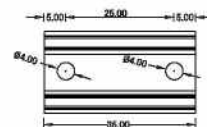

Model	W x H(mm)	Standard Length	Screw Holes	Holes Numbers	Suitable Product
ALC15H05-035	19.38*37.50	35mm	Φ4.0mm	2	F15, SF15
ALC15H05-100		1000mm	○4.0mm	2	F15, SF15
ALC15H05-200		2000mm	○4.0mm	4	F15, SF15

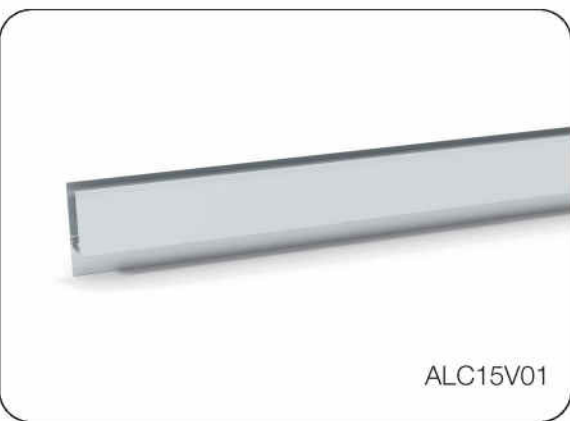

ALC15V01

Unit:mm

Dimension

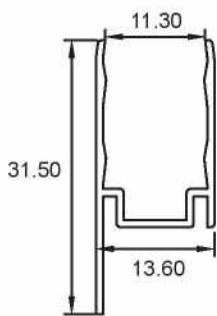

Installation Way

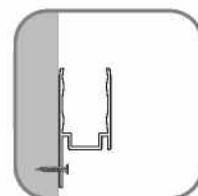

Surface Mounted

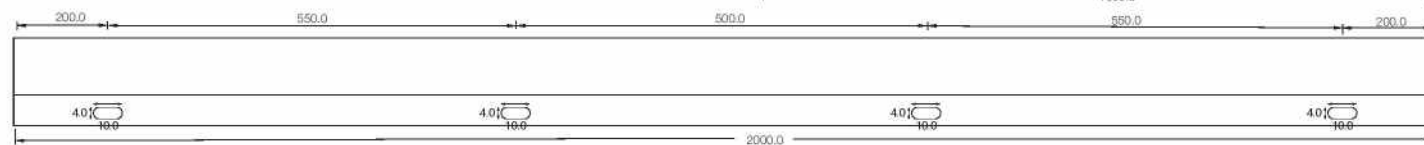
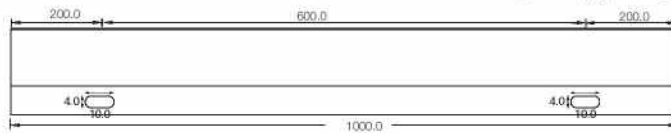
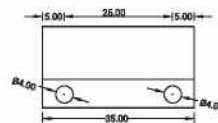

Model	W x H(mm)	Standard Length	Screw Holes	Holes Numbers	Suitable Product
ALC15V01-035	13.60*31.50	35mm	Φ4.0mm	2	F15, SF15
ALC15V01-100		1000mm	○4.0mm	2	F15, SF15
ALC15V01-200		2000mm	○4.0mm	4	F15, SF15

LED Linear Flex Mounting Channel

2. Flexible Aluminum Channel

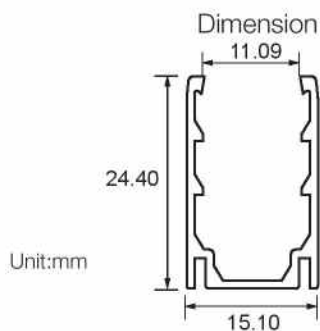

Installation Way

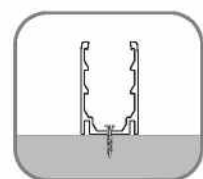

Surface Mounted

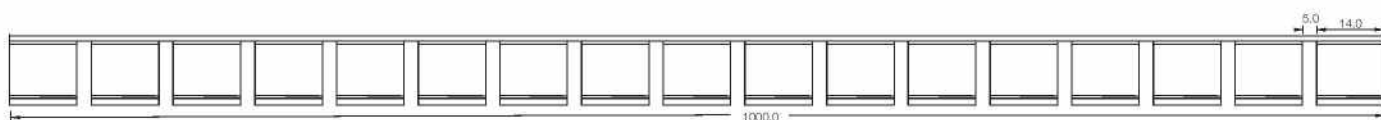
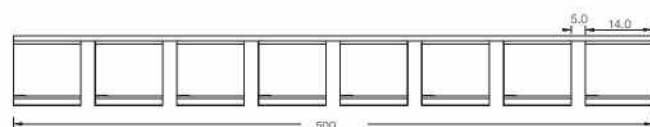

Model	W x H(mm)	Standard Length	Suitable Product
ALC15S01FLX05	15.10*24.40	500mm	F15, SF15
ALC15S01FLX10		1000mm	F15, SF15

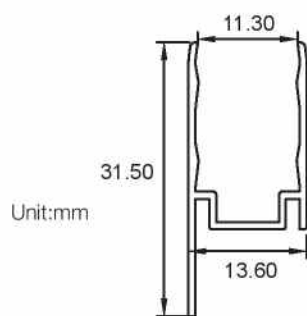

Installation Way

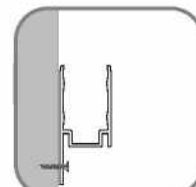

Surface Mounted

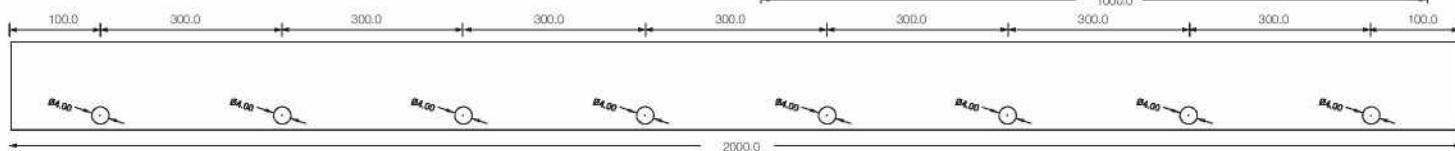
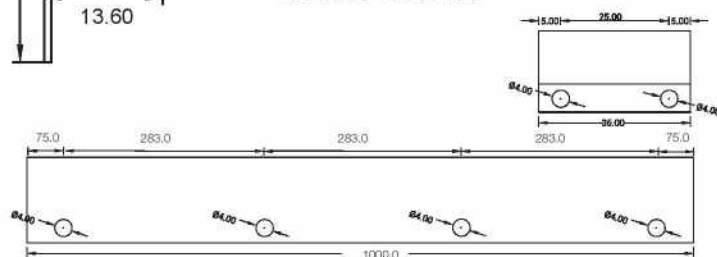

Model	W x H(mm)	Standard Length	Screw Holes	Holes Numbers	Suitable Product
ALC15V01FLX-100	13.60*31.50	1000mm	○4.0mm	4	F15, SF15
ALC15V01FLX-200		2000mm	○4.0mm	8	F15, SF15

LED Linear Flex Mounting Channel

3. Plastic Channel

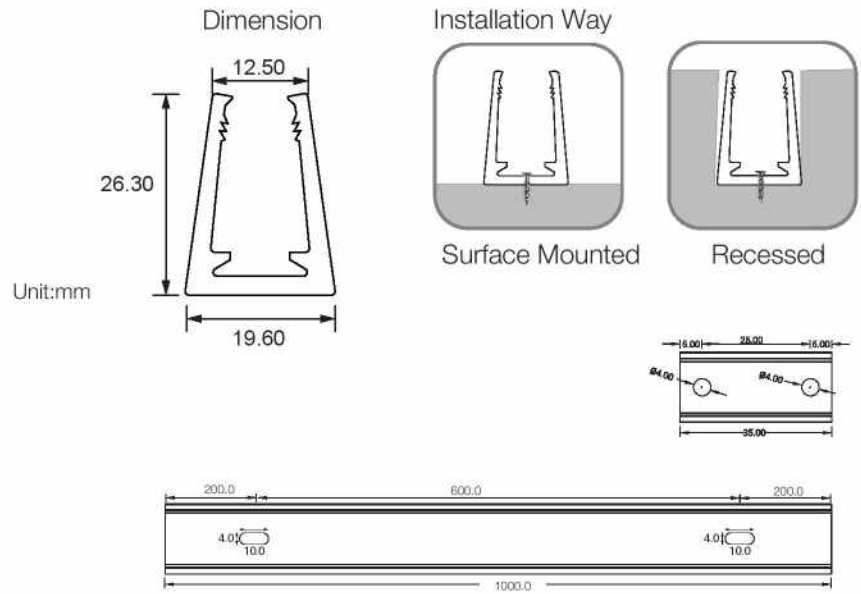

Model	W x H(mm)	Standard Length	Screw Holes	Holes Numbers	Suitable Product
PC15/21S01-T-035	19.60*26.30	35mm	Φ4.0mm	2	F15, SF15
PC15/21S01-T-100		1000mm	○4.0mm	2	F15, SF15

4. Stainless Steel Channel

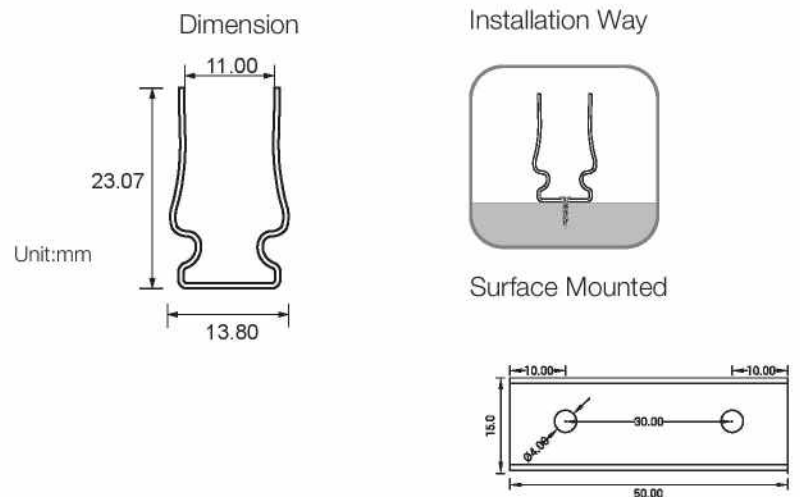

Model	W x H(mm)	Standard Length	Screw Holes	Holes Numbers	Suitable Product
SSC15S01-05	13.80*23.07	50mm	Φ4.0mm	2	F15, SF15

LED Linear Flex Mounting Channel

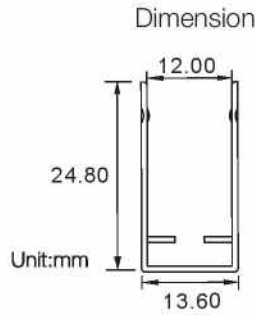

Installation Way

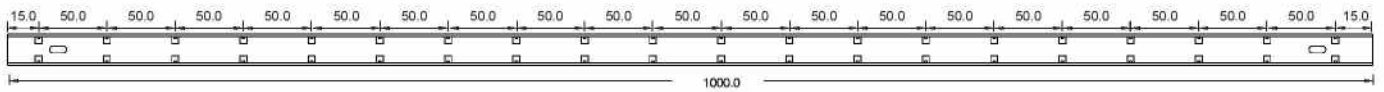
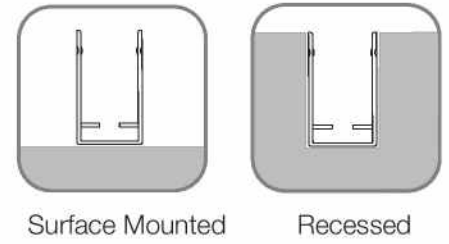

Model	W x H(mm)	Standard Length	Screw Holes	Holes Numbers	Suitable Product
SSC15S02-100	13.60*24.80	1000mm	○4.0x10mm	2	F15, SF15

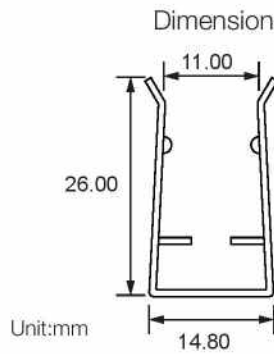
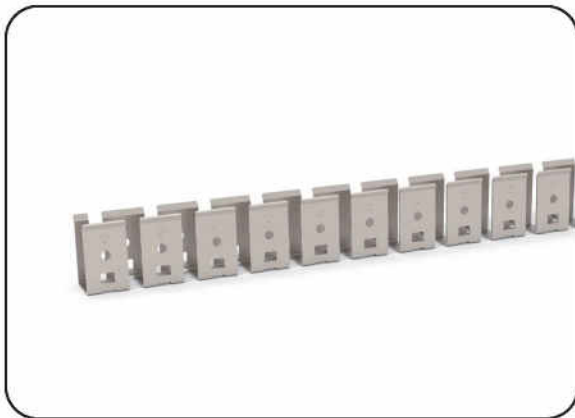

Installation Way

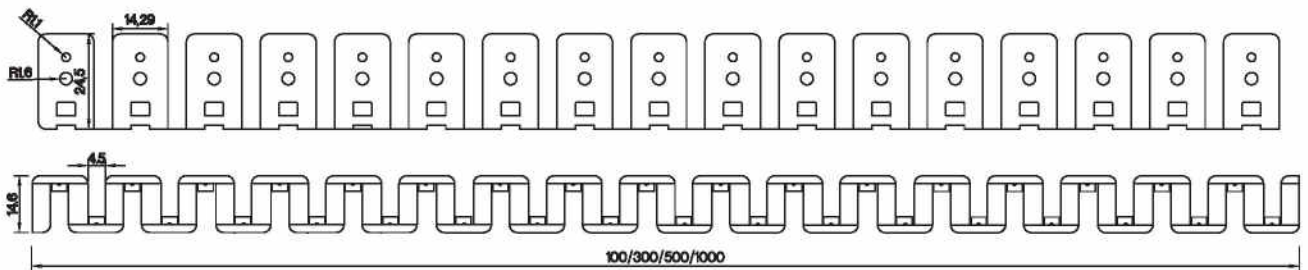
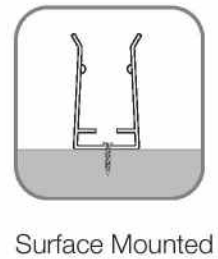

Model	W x H(mm)	Standard Length	Suitable Product
SSC15FLX01	14.80*26.00	100mm	F15, SF15
SSC15FLX03		300mm	F15, SF15
SSC15FLX05		500mm	F15, SF15
SSC15FLX10		1000mm	F15, SF15

LED linear Flex Packing Details



Standard: Carton (Paper Reel Inside)

Product	Max.Length	Carton Size	Net Weight	Gross Weight
F15/SF15	30m	34*34*18cm	12kg	13.6kg
F16/SF16	20m	34*34*18cm	8.6kg	10.2kg
F17/SF17	20m	34*34*18cm	8.6kg	10.2kg
SF18	20m	34*34*18cm	8.6kg	10.2kg
F21/SF21	20m	34*34*18cm	10.4kg	12.0kg
SF10	30m	34*34*18cm	9.6kg	11.2kg
SF09	35m	34*34*18cm	5.8kg	7.4kg
SF08	30m	34*34*18cm	7.2kg	8.8kg
SF06	30m	34*34*18cm	7.2kg	8.8kg



Custom: Carton (White Box+ Plastic Plate Inside)

Product	Package 1 Dimension	Length	Gross Weight	Package 2 Dimension	Length	Gross Weight
F15/SF15	38*38*3cm	5m	2.5kg	45*55*3cm	10m	5kg
F16/SF16	38*38*3cm	5m	2.6kg	51*61*4cm	10m	5.2kg
F17/SF17	38*38*3cm	5m	2.6kg	51*61*4cm	10m	5.2kg
SF18	38*38*3cm	5m	2.6kg	51*61*4cm	10m	5.2kg
F21/SF21	38*38*3cm	5m	3.1kg	51*61*4cm	10m	6.2kg
SF10	38*38*3cm	5m	2.0kg	45*55*3cm	10m	4kg
SF09	38*38*3cm	5m	1.5kg	45*55*3cm	10m	3kg
SF08	38*38*3cm	5m	1.5kg	45*55*3cm	10m	3kg
SF06	38*38*3cm	5m	1.5kg	45*55*3cm	10m	3kg